



**DL-AC-FLEX • INFINA**

Linear Strip  
AC Flexible Linear Strip



## PLUG & PLAY INSTALLATION INSTRUCTIONS

Please read and save these instructions. Read carefully before using product. Protect yourself and others by observing all safety information, warnings and cautions. Failure to comply with instructions could result in personal injury and/or damage to product or property. Please retain instruction sheet for future reference.

**DO NOT CUT, SHORTEN OR SPLICE. DOING SO CAN CAUSE RISK OF ELECTRICAL SHOCK.**

### ! IMPORTANT SAFETY INSTRUCTIONS !

Read completely before beginning. If you feel you do not have adequate electrical wiring experience, have this installed by a qualified licensed electrician.

All electrical connections must be in accordance with local codes, ordinances and the National Electric Code. This product operates on 120 VAC; always confirm the maximum wattage of the linear strip does not exceed the maximum wattage of the circuit it is connected to. If you are unfamiliar with methods of installing electrical wiring, secure the services of a qualified licensed electrician.

- Do not cover this product as the covering may cause the flexible light to overheat and melt or ignite.
- Do not operate with the flexible light tightly coiled.
- Do not puncture, cut, shorten, or splice the flexible lighting.
- Do not route the cord or flexible lighting cable through walls, doors, windows or any like part of the building structure.
- Do not use if there is any damage to the light or cord insulation. Inspect periodically.
- Do not submerge flexible light in liquids, or use the product in the vicinity of standing water or other liquids.
- Secure this flexible light using only hangers or clips provided. Do not secure this product with staples, nails, or like means that may damage the insulation or permanently attach to the building structure.
- Do not subject flexible lighting to continuous flexing.
- Do not Exceed The Length in Feet Permitted By The Marking.
- Do not use with an extension cord unless plug can be fully inserted.
- Do not alter or replace the plug.

**WARNING: When using outdoor use portable lighting product, basic safety precautions should always be followed to reduce the risk of electric shock, and personal injury, including the following:**

#### Read All Instructions

- Ground Fault Circuit Interrupter (GFCI) protection should be provided on the circuits or outlet to be used for the outdoor use flexible lighting product. Receptacles are available having built-in GFCI protection for this measure of safety.
- Use only outdoor extension cords, such as type SW, SOW, STW, STOW, SJW, SJOW, SJTW, or SJTOW. This designation is marked on the wire of the extension

## CORD AND PLUG INSTALLATION

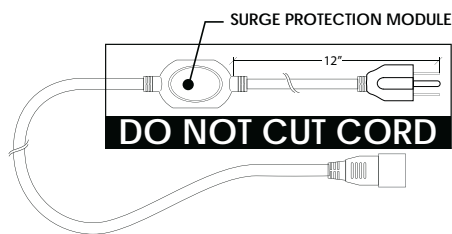

Up to 75ft Run: DL-AC-FLEX-PC2 or DL-AC-FLEX-PC6  
Up to 150ft Run: DL-AC-FLEX-75-PC2

Each power cable has a built-in surge protection module. Cutting the surge protection module off will result in voiding the product warranty and **RISK OF ELECTRICAL SHOCK AND DAMAGING THE PRODUCT**

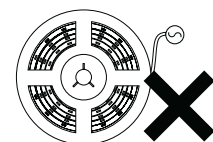
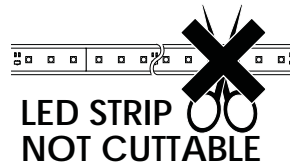
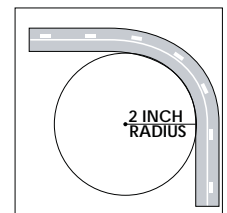
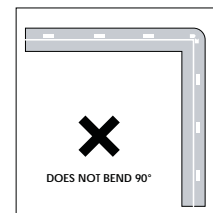
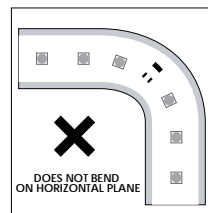

## SAVE THESE INSTRUCTIONS



www.jescocolighting.com  
support@jescocolighting.com  
Tech Support: 855.592.0029

15 Harbor Park Drive  
Port Washington, NY 11050  
Main Line: 800.527.7796  
Fax Line: 855.265.5768

219 South 6th Ave  
City of Industry, CA 91746  
Main Line: 855.654.0110  
Fax Line: 626.333.2955

JW 12/29/2016

Instruction sheet subject to change without prior notice.

Page 1 of 2



# DL-AC-FLEX • INFINA

Linear Strip  
AC Flexible Linear Strip



## PLUG & PLAY INSTALLATION INSTRUCTIONS



**TURN OFF ELECTRICITY**  
at main fuse box (or circuit breaker box)  
before beginning installation by switching  
circuit breaker off or removing fuse.  
MIN 90° C SUPPLY CONDUCTORS.



**CONSULT A QUALIFIED ELECTRICIAN TO  
ENSURE CORRECT BRANCH CIRCUIT**  
RATED 120VOLT AC | 4.95Watt / Foot

### MOUNTING OPTIONS

#### MOUNT WITH MOUNTING CLIP

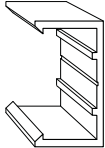

DL-AC-FLEX-MC

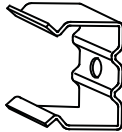

DL-AC-FLEX-MC-M

#### TOOLS REQUIRED

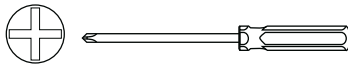

PHILLIPS SCREWDRIVER

#### MOUNT WITH CHANNEL

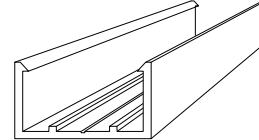

DL-AC-FLEX-CH4 | DL-AC-FLEX-CH8

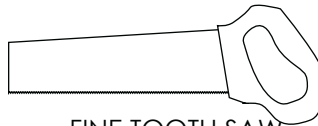

FINE TOOTH SAW

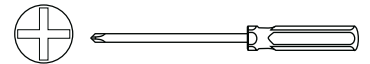

PHILLIPS SCREWDRIVER

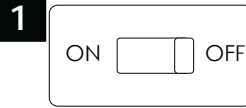

**TURN OFF ELECTRICITY  
AT MAIN FUSE BOX**

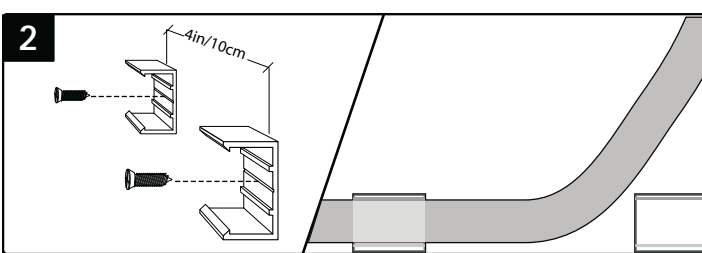

**2** SECURE MOUNTING CLIP ON WALL OR SURFACE WITH SELF TAPPING SCREWS EVERY 4 INCHES. SNAP INFINA INTO MOUNTING CLIPS.

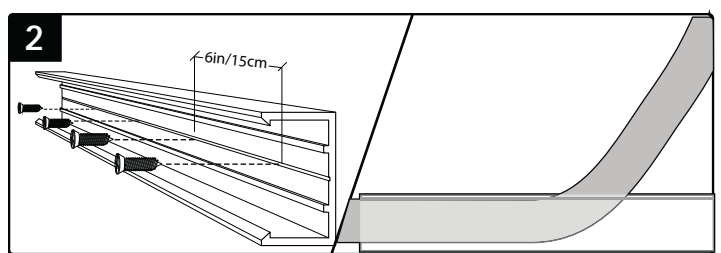

**2** CUT CHANNEL TO SIZE WITH A FINE TOOTH SAW. SECURE CHANNEL ON WALL OR OTHER SURFACES WITH SELF-TAPPING SCREWS EVERY 6 INCHES. SNAP INFINA INTO CHANNEL.

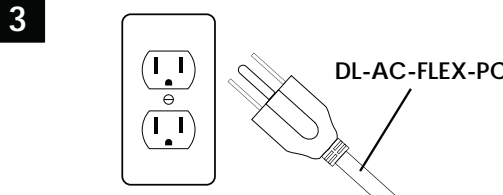

**3** PLUG POWER CABLE INTO A POLARIZED 120V RECEPTACLE AND TURN POWER BACK ON.



www.jescocolighting.com  
support@jescocolighting.com  
Tech Support: 855.592.0029

15 Harbor Park Drive  
Port Washington, NY 11050  
Main Line: 800.527.7796  
Fax Line: 855.265.5768

219 South 6th Ave  
City of Industry, CA 91746  
Main Line: 855.654.0110  
Fax Line: 626.333.2955