



INSTALLATION INSTRUCTIONS

Please read and save these instructions. Read carefully before using product. Protect yourself and others by observing all safety information, warnings and cautions. Failure to comply with instructions could result in personal injury and/or damage to product or property. Please retain instruction sheet for future reference.

* Measure and cut cable to length first

PARTS INCLUDED

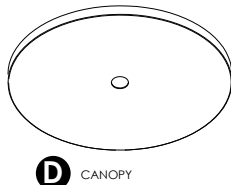
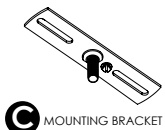

TOOLS & HARDWARE REQUIRED (not included)

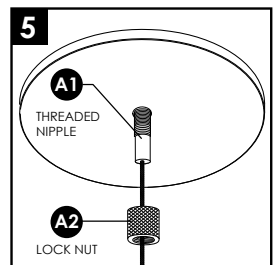
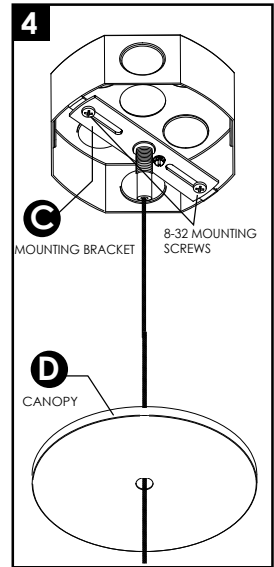
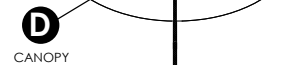
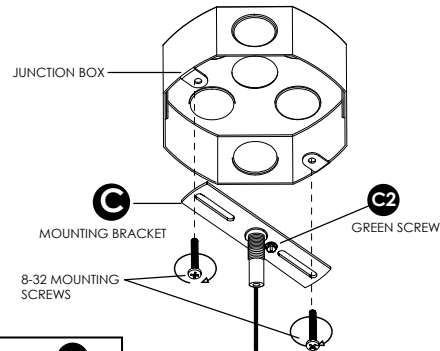
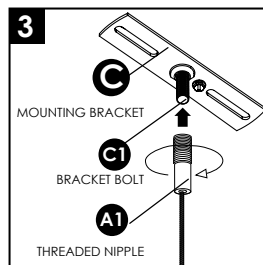
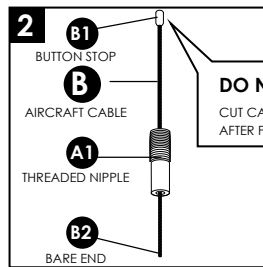
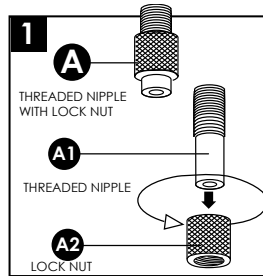
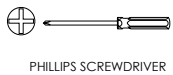

1. Unscrew **A2** lock nut from **A1** threaded nipple and save for later use.
2. Insert **B2** bare end of **B** aircraft cable into **A1** threaded nipple and make sure **B1** button stop sits inside of **A1** threaded nipple.
3. Thread **A1** threaded nipple onto **C1** bracket bolt on **C** mounting bracket.
4. Secure **C** mounting bracket to junction box with two 8-32 mounting screws.
5. Thread **A2** lock nut onto **A1** threaded nipple to secure **D** canopy to junction box.