



**DL-AC-FLEX**

**INFINA® LED FLEXIBLE LINEAR  
AC FLEXIBLE LINEAR STRIP**

PATENT NO.:9,671,075  
PATENT NO.:9,746,144

|             |  |
|-------------|--|
| Type        |  |
| Project     |  |
| Catalog No. |  |

## PLUG & PLAY INSTALLATION INSTRUCTIONS

Please read and save these instructions. Read carefully before using product. Protect yourself and others by observing all safety information, warnings and cautions. Failure to comply with instructions could result in personal injury and/or damage to product or property. Please retain instruction sheet for future reference.

**DO NOT CUT OR SHORTEN INFINA. DOING SO CAN CAUSE RISK OF ELECTRICAL SHOCK.**

### **IMPORTANT SAFETY INSTRUCTIONS**

All electrical connections must be in accordance with local codes, ordinances and the National Electric Code. This product operates on 120 VAC; always confirm the maximum wattage of the linear strip does not exceed the maximum wattage of the circuit it is connected to. If you are unfamiliar with methods of installing electrical wiring, secure the services of a qualified licensed electrician.

- Do not cover this product as the covering may cause the flexible light to overheat and melt or ignite.
- Do not operate with the flexible light while attached to plastic spool or tightly coiled. Excess heat may melt the spool and/or strip light.
- Do not puncture, cut, shorten, or splice the flexible lighting.
- Do not route the cord or flexible lighting cable through walls, doors, windows or any like part of the building structure.
- Do not use if there is any damage to the light or cord insulation. Inspect periodically.
- Do not submerge flexible light in liquids or use the product in the vicinity of standing water or other liquids.
- Do not install near areas with exposure to salt water or chlorinated water.
- Secure this flexible light using only hangers or clips provided. Do not secure this product with staples, nails, or like means that may damage the insulation or permanently attach to the building structure.
- Do not subject flexible lighting to continuous flexing.
- Do not exceed the length in feet permitted by the marking.
- Do not install in environment where LED chips are exposed to direct sunlight as damage to the phosphor will occur.

**WARNING: When using outdoor portable lighting product, basic safety precautions should always be followed to reduce the risk of electric shock, and personal injury, including the following:**

Ground Fault Circuit Interrupter (GFCI) protection should be provided on the circuits or outlet to be used for the outdoor use flexible lighting product. Receptacles are available having built-in GFCI protection for this measure of safety. Use only outdoor extension cords, such as type SW, SOW, STW, STOW, SJW, SJOW, SJTW, or SJTOW. This designation is marked on the outside of the extension.

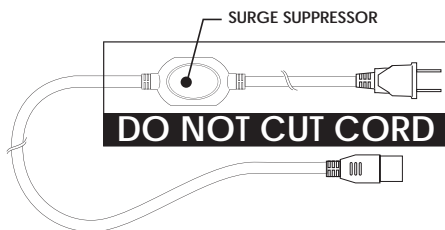

Up to 75ft Run: **DL-AC-FLEX-PC2** or **DL-AC-FLEX-PC6**  
Up to 150ft Run: **DL-AC-FLEX-75-PC2**

Each power cable has a built-in surge suppressor. Cutting the surge module off will result in voiding the product warranty and **RISK OF ELECTRICAL SHOCK AND DAMAGING THE PRODUCT**

### **DO NOT CUT CORD FOR HARDWIRE INSTALLATION**

Contact your local representative on the correct parts for hardwire installation

## SAVE THESE INSTRUCTIONS

**JESCO**  
LIGHTING GROUP

© 2015 JESCO LIGHTING GROUP, LLC

www.jescolighting.com  
support@jescolighting.com  
Tech Support: 855.592.0029

15 Harbor Park Drive  
Port Washington, NY 11050  
Main Line: 800.527.7796  
Fax Line: 855.265.5768

219 South 6th Ave  
City of Industry, CA 91746  
Main Line: 855.654.0110  
Fax Line: 626.333.2955



Installation sheet subject to change without prior notice.



# DL-AC-FLEX

INFINA® LED FLEXIBLE LINEAR  
AC FLEXIBLE LINEAR STRIP

PATENT NO.:9,671,075  
PATENT NO.:9,746,144

|             |  |
|-------------|--|
| Type        |  |
| Project     |  |
| Catalog No. |  |

## PLUG & PLAY INSTALLATION INSTRUCTIONS



### TURN OFF ELECTRICITY

at main fuse box (or circuit breaker box) before beginning installation by switching circuit breaker off or removing fuse. MIN 90° C SUPPLY CONDUCTORS.



### CONSULT A QUALIFIED ELECTRICIAN TO ENSURE CORRECT BRANCH CIRCUIT

RATED 120VOLT AC | 4.95Watt / Foot

**MOUNTING OPTIONS** Excluding metal channel mounting, please see DL-AC-FLEX-CH6-M installation sheet

#### MOUNT WITH MOUNTING CLIP

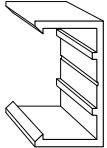

DL-AC-FLEX-MC



DL-AC-FLEX-MC-M

#### TOOLS REQUIRED

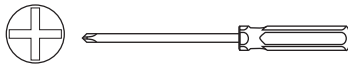

PHILLIPS SCREWDRIVER

#### MOUNT WITH CHANNEL

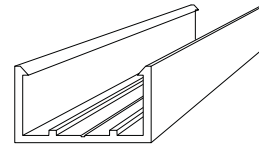

DL-AC-FLEX-CH4 | DL-AC-FLEX-CH8



FINE TOOTH SAW



PHILLIPS SCREWDRIVER



**TURN OFF ELECTRICITY AT MAIN FUSE BOX**

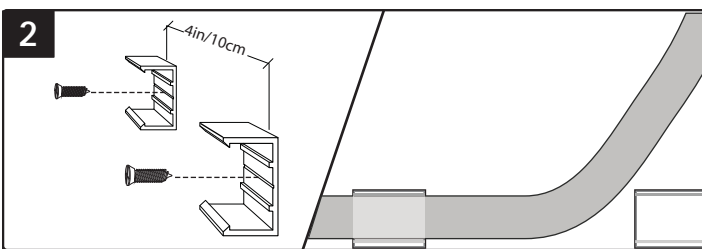

SECURE MOUNTING CLIP ON WALL OR SURFACE WITH SELF TAPPING SCREWS EVERY 4 INCHES. SNAP INFINA INTO MOUNTING CLIPS.

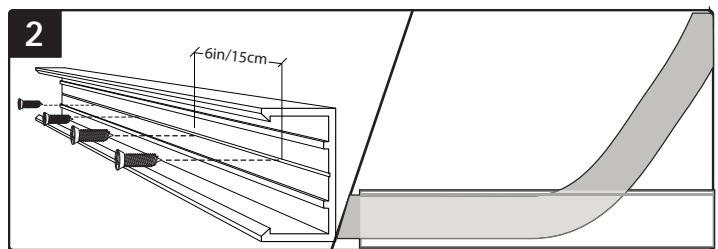

CUT CHANNEL TO SIZE WITH A FINE TOOTH SAW. SECURE CHANNEL ON WALL OR OTHER SURFACES WITH SELF-TAPPING SCREWS EVERY 6 INCHES. SNAP INFINA INTO CHANNEL.

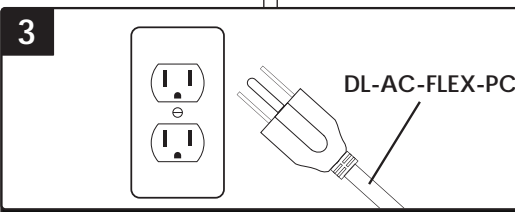

PLUG POWER CABLE INTO A POLARIZED 120V RECEPTACLE AND TURN POWER BACK ON.

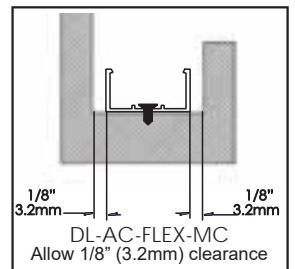

© 2015 JESCO LIGHTING GROUP, LLC

www.jescolighting.com  
support@jescolighting.com  
Tech Support: 855.592.0029

15 Harbor Park Drive  
Port Washington, NY 11050  
Main Line: 800.527.7796  
Fax Line: 855.265.5768

219 South 6th Ave  
City of Industry, CA 91746  
Main Line: 855.654.0110  
Fax Line: 626.333.2955



Installation sheet subject to change without prior notice.



**DL-AC-FLEX**

**INFINA® LED FLEXIBLE LINEAR  
AC FLEXIBLE LINEAR STRIP**

PATENT NO.:9,671,075  
PATENT NO.:9,746,144

|             |  |
|-------------|--|
| Type        |  |
| Project     |  |
| Catalog No. |  |

## PLUG & PLAY INSTALLATION INSTRUCTIONS

### TROUBLESHOOTING

| PROBLEM  | POSSIBLE CAUSE  | CORRECTION  |
|--|---|---|
| LED strip is not lighting up   | 1. Check main fuse box and GFIC receptacle, ensure breaker has not been tripped   | 1. Switch on breaker.   |
| Some LEDs are not functional   | 1. Product may have been bent excessively, potentially breaking connections.  | 1. Disconnect. Product warranty may have been voided, contact your local distributor.   |
| LEDs are flickering or fluttering  | 1. Product may have been bent excessively or bent on horizontal plane, potentially breaking connections<br>2. Electric current may be distorted by heavy machinery, such as: refrigerator, power tools, commercial printer... | 1. Disconnect. Product warranty may have been voided, contact your local distributor.<br>2. Disconnect any heavy machinery that may be connected to the same circuit as the product.  |
| LEDs have uneven color   | 1. Product may have been painted over or covered with foreign substance.<br>2. Product's operating temperature may have been exceeded.<br>3. Product may have been exposed to direct sunlight for prolong period of time.     | 1. Clean product with non-corrosive cleaners.<br>2. Disconnect. Product warranty may have been voided, contact your local distributor.<br>3. Disconnect. Product warranty may have been voided, contact your local distributor. |
| Some LEDs and intgral circuit chips appears oxidized with brown or green marks | 1. Product may have been submerged in puddle of water or snow for a period of time.<br>2. Product may have been altered in field.   | 1. Disconnect. Product warranty may have been voided, contact your local distributor.<br>2. Disconnect. Product warranty may have been voided, contact your local distributor.  |
| The outer jacket appears charred   | 1. Product may have been energized when tightly coiled or when it was wound up in a spool.  | 1. Disconnect. Product warranty may have been voided, contact your local distributor.   |
| Plastic mounting channel bowed   | 1. Mounting channel may not have enough mounting screws installed.  | 1. Install mounting screws on mounting channel every 6 inches.  |
| LED strip is too long or too short for installation                            | 1. Inccorrect measurements may have given to factory fo production.   | 1. Contact your local distributor. Do not attempt to splice or field shorten the product. Doing so will void product warranty and UL safety.  |



© 2015 JESCO LIGHTING GROUP, LLC

www.jescolighting.com  
support@jescolighting.com  
Tech Support: 855.592.0029

15 Harbor Park Drive  
Port Washington, NY 11050  
Main Line: 800.527.7796  
Fax Line: 855.265.5768

219 South 6th Ave  
City of Industry, CA 91746  
Main Line: 855.654.0110  
Fax Line: 626.333.2955



Installation sheet subject to change without prior notice.



DL-AC-FLEX

INFINA® LED FLEXIBLE LINEAR  
AC FLEXIBLE LINEAR STRIP

PATENT NO.:9,671,075  
PATENT NO.:9,746,144

|             |  |
|-------------|--|
| Type        |  |
| Project     |  |
| Catalog No. |  |

## PLUG & PLAY INSTALLATION INSTRUCTIONS

# CAUTION

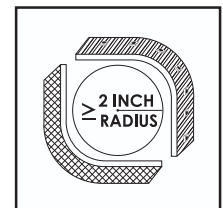
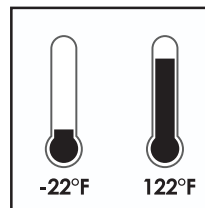
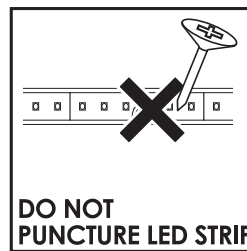
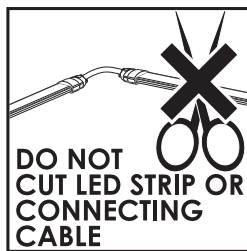
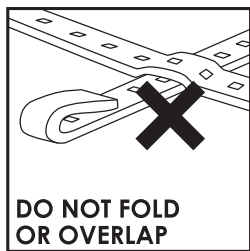
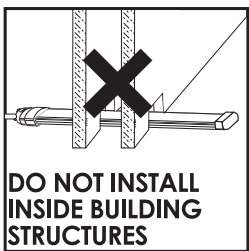
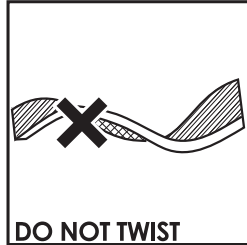
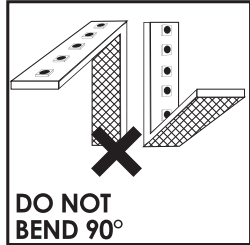

**NOTE:** Avoid installing at locations with prolonged exposure to direct sunlight to prevent extended heat buildup and to prevent irreversible damages on the LED.

## WARRANTY IS VOID IF ANY OF THE ABOVE ARE VIOLATED

A 5 YEAR LIMITED WARRANTY for applications that necessitate up to 16 consecutive operational hours per 24 hour period.  
A 2 YEAR LIMITED WARRANTY for applications that necessitate more than 16 consecutive operational hours per 24 hour period.

**JESCO**  
LIGHTING GROUP

© 2015 JESCO LIGHTING GROUP, LLC

www.jescolighting.com  
support@jescolighting.com  
Tech Support: 855.592.0029

15 Harbor Park Drive  
Port Washington, NY 11050  
Main Line: 800.527.7796  
Fax Line: 855.265.5768

219 South 6th Ave  
City of Industry, CA 91746  
Main Line: 855.654.0110  
Fax Line: 626.333.2955



Installation sheet subject to change without prior notice.