

DL-AC-FLEX2-LNTB

INFINA® 2 AC LED NEO SERIES
DRIVERLESS TOP COLOR BENDING LED NEON



Fixture Type
Project
Notes



INFINA® DL-AC-FLEX2 is the next generation flexible lighting system that incorporates JESCO's exclusive, constant current, driverless AC LED technology which operates directly off of line voltage - no additional power source required and no drivers to hide. Up to a max run length of 164 feet** The product can be dimmed with a TRIAC dimmer². May be mounted either in a snap-in channel or with snap-in mounting clips. INFINA® is designed for dry, damp and wet locations. The LEDs are imbedded within a flexible, frosted, diffused silicone jacket. For easy installation, JESCO offers a full complement of connectors.



120V AC
 DIMMABLE
 3SDCM
 1BIN
 12 IN MIN RUN
 164 FT MAX RUN
 WET OUTDOOR
 DIRECT SUNLIGHT
 IP65
 -4° to 113° F
 L70 50,000 HOURS
 5 YEAR WARRANTY

SPECIFICATIONS

INPUT VOLTAGE¹	120V AC ¹
WATTAGE	3.0 W/Ft
LUMENS	See performance chart below
LED / Ft.	40 LEDs / Ft.
COLOR RENDERING INDEX	90+
COLOR CONSISTENCY	3 Steps MacAdam
BEAM ANGLE	120°
DIMMING²	TRIAC ²
DIMENSIONS	5/16" W x 13/16" H (15mm W x 21mm H)
MAX RUN³ / MIN RUN	164 feet ³ / 12 inch
ENVIRONMENT	Indoor / Outdoor ⁴ - dry, damp and wet
CERTIFICATIONS	ETLus
LUMEN MAINTENANCE⁵	50,000 hours ⁵
WARRANTY⁶	5 years ⁶

¹ 277V AC requires a step-down transformer with 120V AC output
² Never exceed dimmer max wattage. Effectively dim down to 10%.
³ Connecting cable to be taken into consideration when calculating total length
⁴ Hardwire only, [see page 4](#) for all cautions
⁵ TM21 Calculation based on LM80 report
⁶ 120V INFINA® 2.0, and INFINA® shall have a [five \(5\) year limited warranty](#) from the date of shipment. INFINA® 2.0, and INFINA® are deemed defective if there is a failure of 10% or more of the LED component. See specification sheet and installation instructions for more information. Where a replacement is warranted, custom ordered INFINA® 2.0, and INFINA® will only be replaced as originally ordered.

PERFORMANCE

COLOR TEMPERATURE ⁷	LUMEN ⁸	WATTAGE	EFFICACY
RED	28 Lm	3.0 W	9.3 Lm/W
GREEN	175 Lm	3.0 W	58.3 Lm/W
BLUE	20 Lm	3.0 W	6.7 Lm/W
AMBER	118 Lm	3.0 W	39.3 Lm/W
PINK	98 Lm	3.0 W	32.7 Lm/W

^{7/8} CCT within +/- 10%

BASIC ORDERING INFO

Download product configurator for complex connected runs

STEP 1 TERMINATIONS

MODEL	INPUT SIDE	INPUT TYPE
DL-AC-FLEX2-LNTB-	TS - Tail Side	HW08 - Hardwire 8ft cord
	ES - Edge Side*	HW20 - Hardwire 20ft cord
	<input type="checkbox"/> LEFT <input type="checkbox"/> RIGHT	PC02 - Plug-in 2ft cord
		PC06 - Plug-in 6ft cord

* When **ES** is selected, must choose left or right side input

STEP 2 CCT / LENGTH

MODEL	COLOR	LENGTH
DL-AC-FLEX2-LNTB-	RD - RED	12" increments
	GN - GREEN	
	BU - BLUE	
	AM - AMBER	
	PK - PINK	

STEP 3 ENDCAP⁹

MODEL
DL-AC-FLEX2-LNTB-EC
Installed and sealed from factory

STEP 4

MOUNTING ACCESSORIES
See [page 3](#)

⁹ Required one per each run

DL-AC-FLEX2-LNTB

INFINA® 2 AC LED NEO SERIES
DRIVERLESS TOP COLOR BENDING LED NEON



Fixture Type
Project
Notes

TERMINATION OPTIONS

Factory sealed to DL-AC-FLEX2-LNTB strip

PART NUMBER	DL-AC-FLEX2-LNTB-TS-HW(08/20)
DESCRIPTION	8' / 20' cord with hardwire leads tail side
ENVIRONMENT	Indoor, Outdoor
DIMENSIONS	A 1" (25 mm) B 1 3/16" (20mm) C 1 1/2" (38mm) HW08 8' (2438mm) HW20 20' (6096mm)

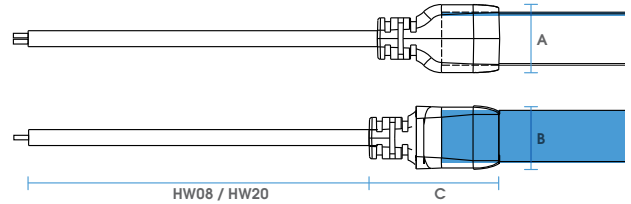

PART NUMBER	DL-AC-FLEX2-LNTB-ES-HW(08/20)
DESCRIPTION	8' / 20' cord with hardwire leads edge side Must choose top or bottom side
ENVIRONMENT	Indoor, Outdoor
DIMENSIONS	A 1" (25 mm) B 1 3/16" (20mm) HW08 8' (2438mm) HW20 20' (6096mm)

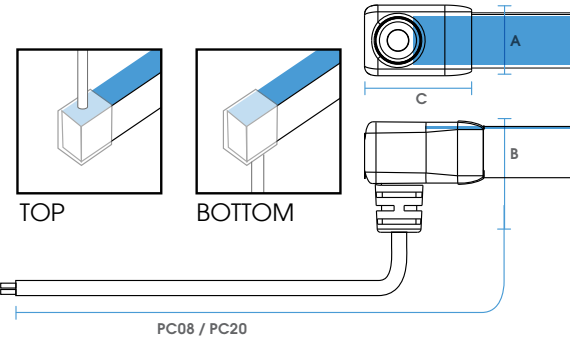

PART NUMBER	DL-AC-FLEX2-LNTB-TS-PC(02/06)
DESCRIPTION	2' / 6' Cord with 2 prongs plug with 8A fuse
ENVIRONMENT	Indoor Only
DIMENSIONS	A 1" (25 mm) B 1 3/16" (20mm) C 1 1/2" (38 mm) PC02 2' (609mm) HW06 6' (1828mm)

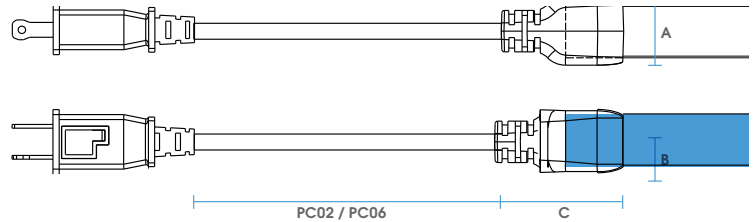

PART NUMBER	DL-AC-FLEX2-LNTB-ES-PC(02/06)
DESCRIPTION	2' / 6' Cord with 2 prongs plug with 8A fuse Must choose top or bottom side
ENVIRONMENT	Indoor Only
DIMENSIONS	A 1" (25 mm) B 1 3/16" (40mm) PC02 2' (609mm) HW06 6' (1828mm)

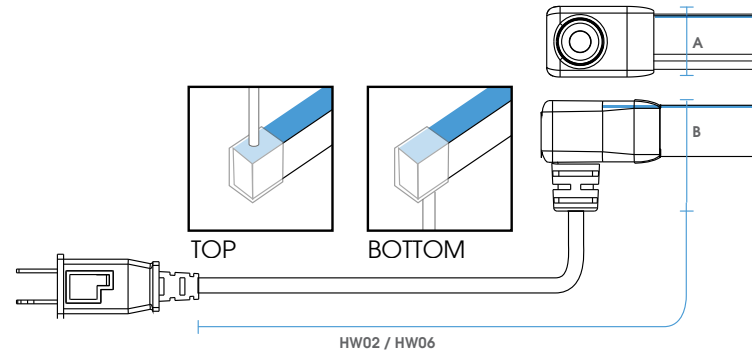

PART NUMBER	DL-AC-FLEX2-LNTB-EC
DESCRIPTION	Endcap, one required per run
ENVIRONMENT	Indoor, Outdoor
DIMENSIONS	A 1 3/16" (20 mm) B 5/8" (16mm) C 1 3/16" (20mm)

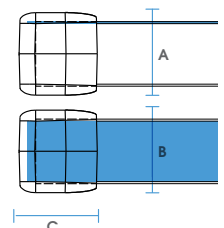

DL-AC-FLEX2-LNTB

INFINA® 2 AC LED NEO SERIES
DRIVERLESS TOP COLOR BENDING LED NEON



Fixture Type
Project
Notes

MOUNTING OPTIONS

Factory sealed to DL-AC-FLEX2-LNTB strip

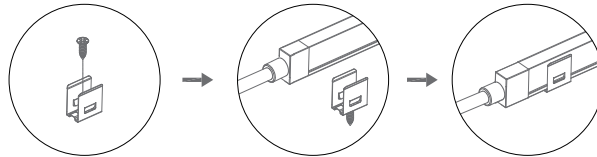

PART NUMBER	DL-AC-FLEX2-LNTB-BR
DESCRIPTION	Metal mounting bracket
ENVIRONMENT	Indoor, Outdoor

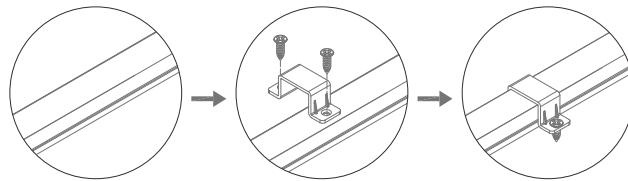
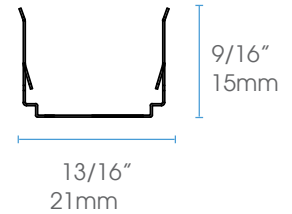
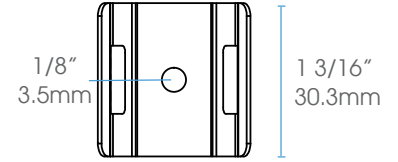

PART NUMBER	DL-AC-FLEX2-LNTB-MC
DESCRIPTION	Plastic mounting clip
ENVIRONMENT	Indoor, Outdoor

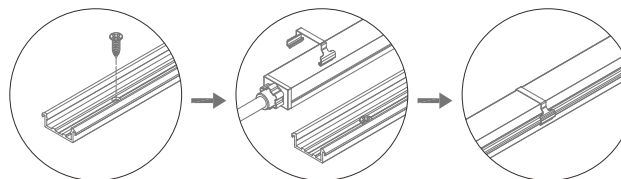
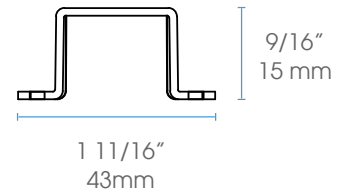

PART NUMBER	DL-AC-FLEX2-LNTB-CH3M22
DESCRIPTION	3FT Metal mounting channel with clasp
ENVIRONMENT	Indoor, Outdoor

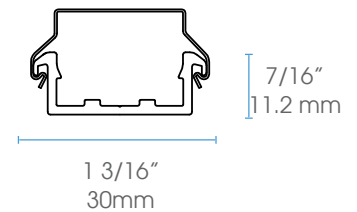

DL-AC-FLEX2-LNTB

INFINA® 2 AC LED NEO SERIES • DRIVERLESS TOP COLOR BENDING LED NEON



CAUTIONS

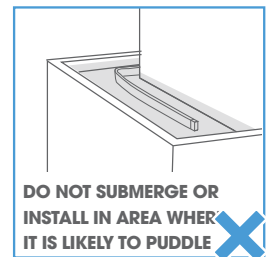
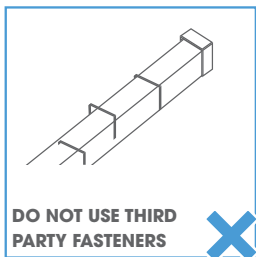
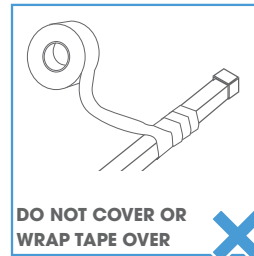
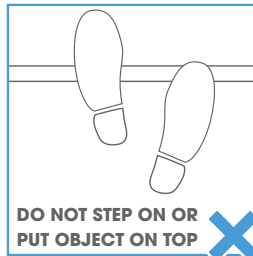
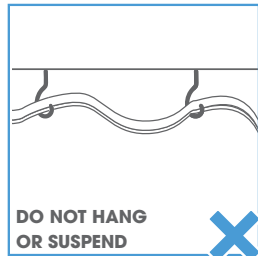
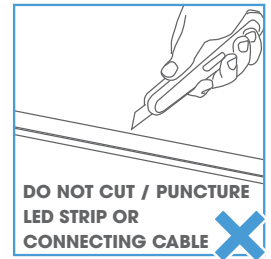
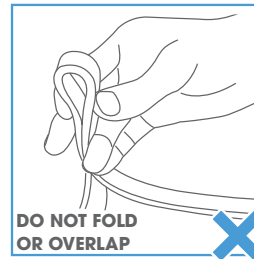
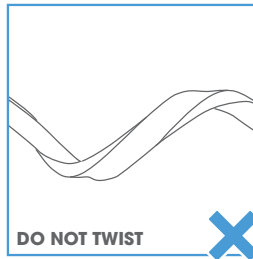
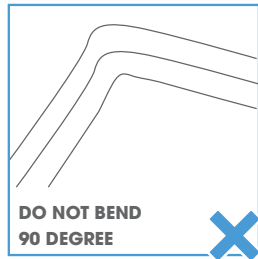
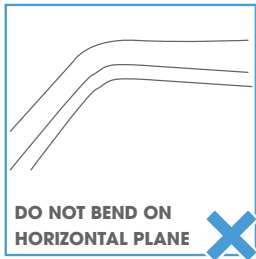

OUTDOOR - DO NOT INSTALL

- NEAR AREAS WITH EXPOSURE TO SALT WATER OR CHLORINATED WATER



AVOID - DO NOT INSTALL

- CLOSE TO A SWIMMING POOL
- IN CABINETS, TANKS OR ENCLOSURES OF ANY KIND
- NEAR FLAMMABLE OR CORROSIVE LIQUIDS



≥ 3 INCH RADIUS

IP65

-4°F 113°F

CONNECTS TO GFCI CIRCUITS ONLY

HARDWIRE APPLICATIONS

FUSE HOLDER MUST BE INSTALLED IN THE JUNCTION BOX

FUSE HOLDER WITH 6.3A FUSE (included)

install between the positive leads of the fixture and the power

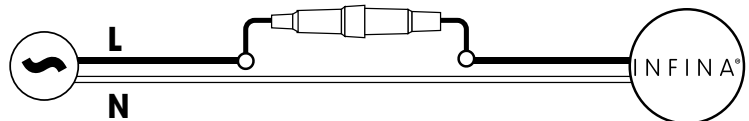

FOR HARDWIRE APPLICATIONS, A PROVIDED HW CLIP MUST BE INSTALLED AT THE BEGINNING AND END OF EACH SECTION

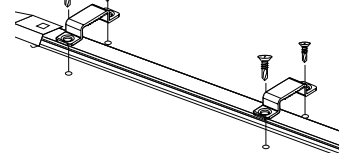

WARRANTY IS VOID IF ANY OF THE ABOVE ARE VIOLATED