

DMX CONTROLLER LC-PC-400

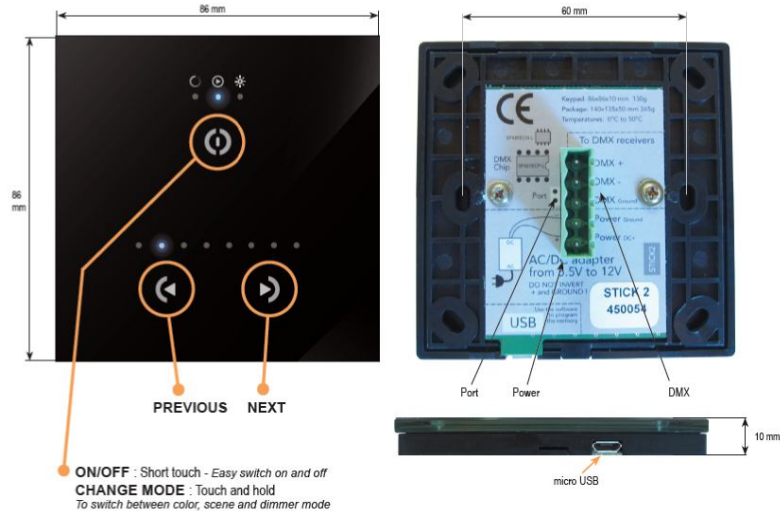

DESCRIPTION

The LC-PC-400 is a wall mounted stand alone touch sensitive DMX lighting controller with a glass face. The sensitive keys enable you to comfortably modify the lighting effects. The touch sensitive keypad allows colors and brightness levels to be controlled easily.

SPECIFICATION

Package	Interface, CD with software and instructions, usb cable, hardwire power supply
PC requirement*	Windows XP/VISTA/7 32/64 bits and USB 2.0
Software Included	ESA (easy stand alone)
User Interface	3 buttons
Memory	3K
USB	2.0 USB Port for PC
Color†	Black
Operating Temperature	0°C to 50°C
Dimensions	3-3/8"L x 3-3/8"W x 7/16"H

* Apple operating systems are currently not supported (Mac OS X).

† Consult factory for pricing and availability for white version (LC-PC-400-WH).

PROGRAM CAPACITY

Channels in Use	8	16	32	48	64	80	96	112	128
Max Steps	326	192	102	68	50	38	31	25	21

An RGB fixture consists of 3 channels. An area consisting of 10 RGB fixtures controlled at the same time will have 3 channels in use. If all 10 RGB fixtures are controlled individually then 30 channels will be in use.

SUBMITTAL

Job Name:	Date:
Specification Type:	Job Location:
Drawing Location of Fixture Type:	Approval:
Specifier Name:	Sales Agency Contact:
Contact Phone/Email:	Contact Phone/Email:



JESCO LIGHTING GROUP
 6625 TRAFFIC AVE
 GLENDALE, NY 11385

800.527.7796
WWW.JESCOLIGHTING.COM

Specifications subject to
 change without prior notice
 Rev 2
 9/23/2011
 Page 1 of 2

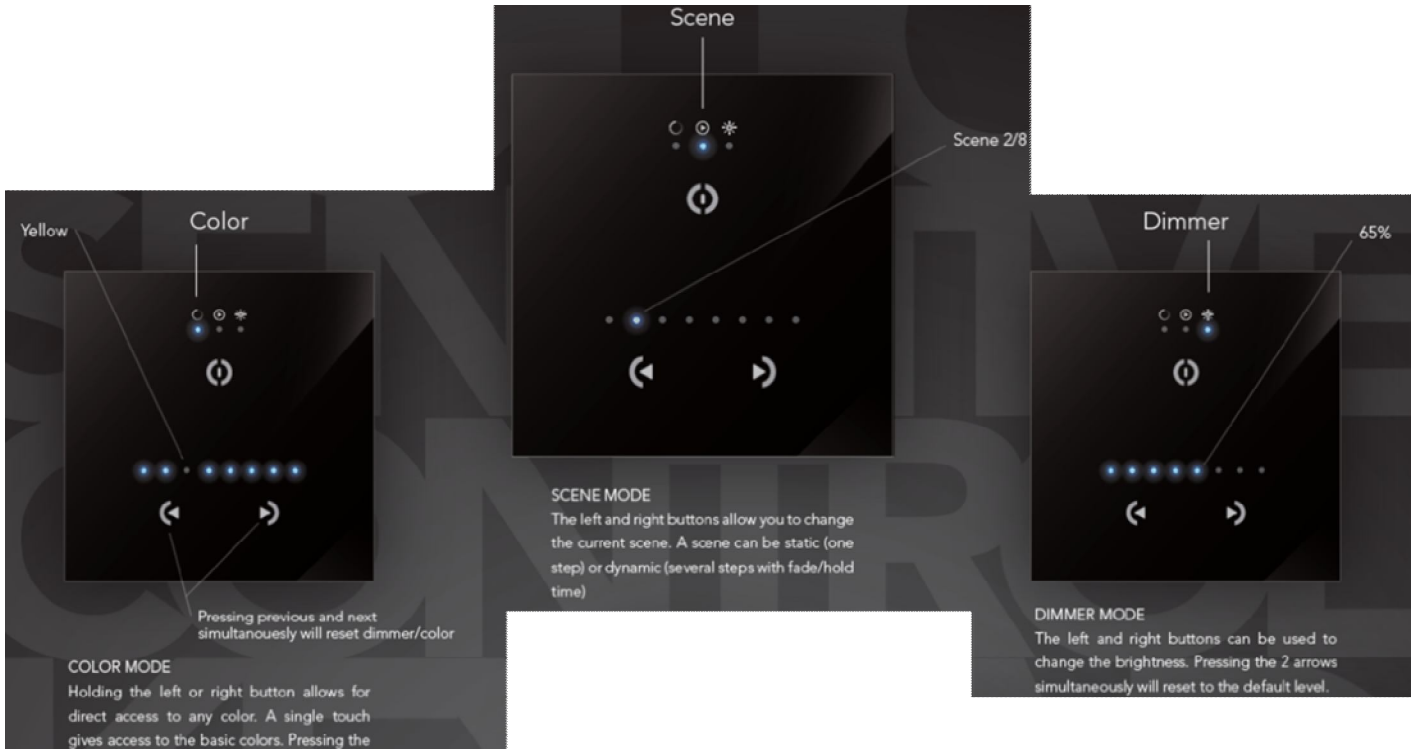

SUBMITTAL

Job Name:	Date:
Specification Type:	Job Location:
Drawing Location of Fixture Type:	Approval:
Specifier Name:	Sales Agency Contact:
Contact Phone/Email:	Contact Phone/Email:



JESCO LIGHTING GROUP
 6625 TRAFFIC AVE
 GLENDALE, NY 11385

800.527.7796
WWW.JESCOLIGHTING.COM

Specifications subject to
 change without prior notice
 Rev 2
 9/23/2011
 Page 2 of 2