

# DIM-TO-WARM

## FLEXIBLE LINEAR LED STRIP



# DIM-TO-WARM FLEXIBLE LED LINEAR STRIP



Actual size shown



## APPLICATIONS

- Cove and soffit lighting
- Accent lighting
- Under-shelf & under-cabinet lighting
- Path, contour, and edge lighting

## HIGHLIGHTS

- Smoothly mimics the dimming curve of an incandescent lamp
- 3000K at full brightness - dims down to 1800K
- A very high LED density - 72 LEDs/ft - eliminating hotspots
- 3-Step MacAdam LED binning for uniformity in both color and intensity
- Precise sizing - field-cutable approximately every 2 inches
- Easy installation with 3M® adhesive tape
- Large variety of channel and lens options available
- 3oz. PCB thickness for optimal thermal management, mitigates voltage drop as the run length increases

## DL-FLEX2-DTW-3018

DIM-TO-WARM FLEXIBLE LED LINEAR STRIP

LED	24V DC	5.30 W/FT	302* Lm/FT	57* Lm/W	72 LED/FT	90+ CRI
16.4' MAX	~2" MIN	120°	0-10V	DRY	UL LISTED	

**Dims:** 7/16" W x 1/16" H

**Dimming:** 0-10V

**Environment:** Indoor - Dry

\* Lumen data shown @3000K, maximum brightness.  
Based on DL-PS-XX/24-JB-OD-DIM

## TO ORDER

MODEL

**DL-FLEX2-DTW**

CCT RANGE

**3018**

**3018** - 3000K - 1800K

Specifications subject to change without notice.

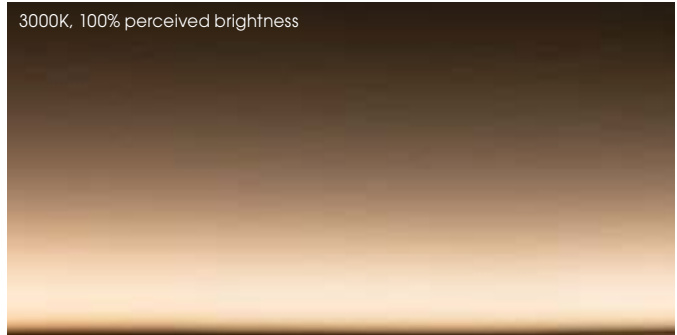

3000K, 100% perceived brightness



2700K, 70% perceived brightness



2200K, 40% perceived brightness

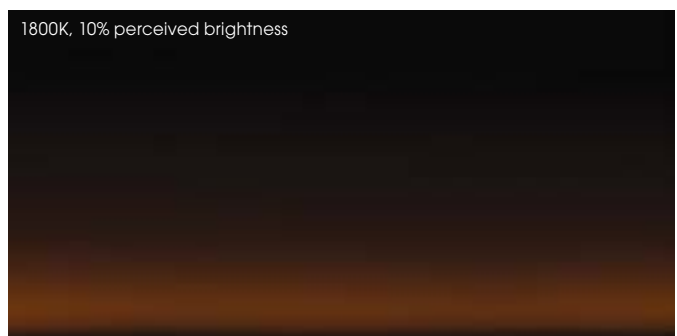

1800K, 10% perceived brightness

Dimming shown for 0-10V dimmable drivers



JESCOLIGHTING.COM • 800 527 7796 • info@jescolighting.com

# DIM-TO-WARM FLEXIBLE LED LINEAR STRIP

## ACCESSORIES



**DL-FLEX2-CLAMP-PC-HW-10B**  
Clamp Connector with hardwire power cord. 12" cable length.



**DL-FLEX2-CLAMP-CC3-10B**  
Connecting cable with 3" wire

**DL-FLEX2-CLAMP-CC6-10B**  
Connecting cable with 6" wire

**DL-FLEX2-CLAMP-CC12-10B**  
Connecting cable with 12" wire

## CONNECTORS



**DL-FLEX2-CLAMP-WT10B**  
Wire to Tape Clamp Connector



**DL-FLEX2-CLAMP-TT10B**  
Tape to Tape Clamp Connector

## RECOMMENDED 0-10V DIMMABLE DRIVERS

<b>DL-PS-30/24-JB-OD-DIM</b>	30W - 24V	24V Hardwire 0-10V Dimmable Power Supplies in Junction Box UL Listed
<b>DL-PS-60/24-JB-OD-DIM</b>	60W - 24V	
<b>DL-PS-96/24-JB-OD-DIM</b>	96W - 24V	

Check latest Specifications for list of recommended dimmers



Full brightness

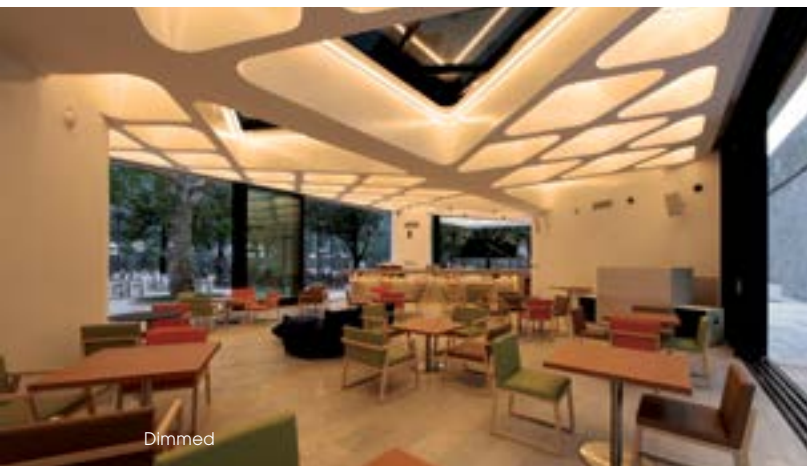

Dimmed



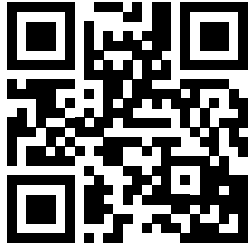

For more details and product specifications please visit [JESCOLIGHTING.COM](http://JESCOLIGHTING.COM)



**NEW YORK  
CORPORATE OFFICE**

15 Harbor Park Drive  
Port Washington NY 11050  
TEL 800 527 7796  
FAX 855 265 5768

**LOS ANGELES**

219 South 6th Avenue  
City Of Industry CA 91746  
TEL 626 333 3661  
TEL 855 654 0110  
FAX 626 333 2955

[JESCOLIGHTING.COM](http://JESCOLIGHTING.COM)  
[info@jescolighting.com](mailto:info@jescolighting.com)

© 2020 JESCO Lighting

LCAT-DTW

